

# Construction Work Zone Signs

**Delivery:** Prompt delivery of work zone signs to meet our customers' needs.  
*Give us a try... you will like our service!*

**Prismatic Reflective Sheetings:** 3924S (Fluorescent Orange Diamond Grade),  
 3934 (High Intensity Prismatic), and 4084 (DG3).

**Substrates:** We stock 3 substrates for timely delivery of your order:



**4MM or 10MM Corrugated Plastic** is the lightest weight sign material available. It is perfect for signs mounted on Type III barricades.



**ACM Material** is a terrific alternative for MDO plywood or roll-up signs and can even be used for signs mounted on Type III barricades.



**.080 Aluminum:** the most durable substrate available.



- ✓ *Competitively Priced*
- ✓ *Huge Inventory*
- ✓ *Great Lead Times*

**Non-stock orders available in 1-week or less!**

**Sizes Available:**  
 48" x 48", 36" x 36", 30" x 30",  
 48" x 24", 60" x 24", and more.

**The Largest Inventory of Fluorescent Orange Construction Work Zone Signs and Border Blanks in the Industry!**

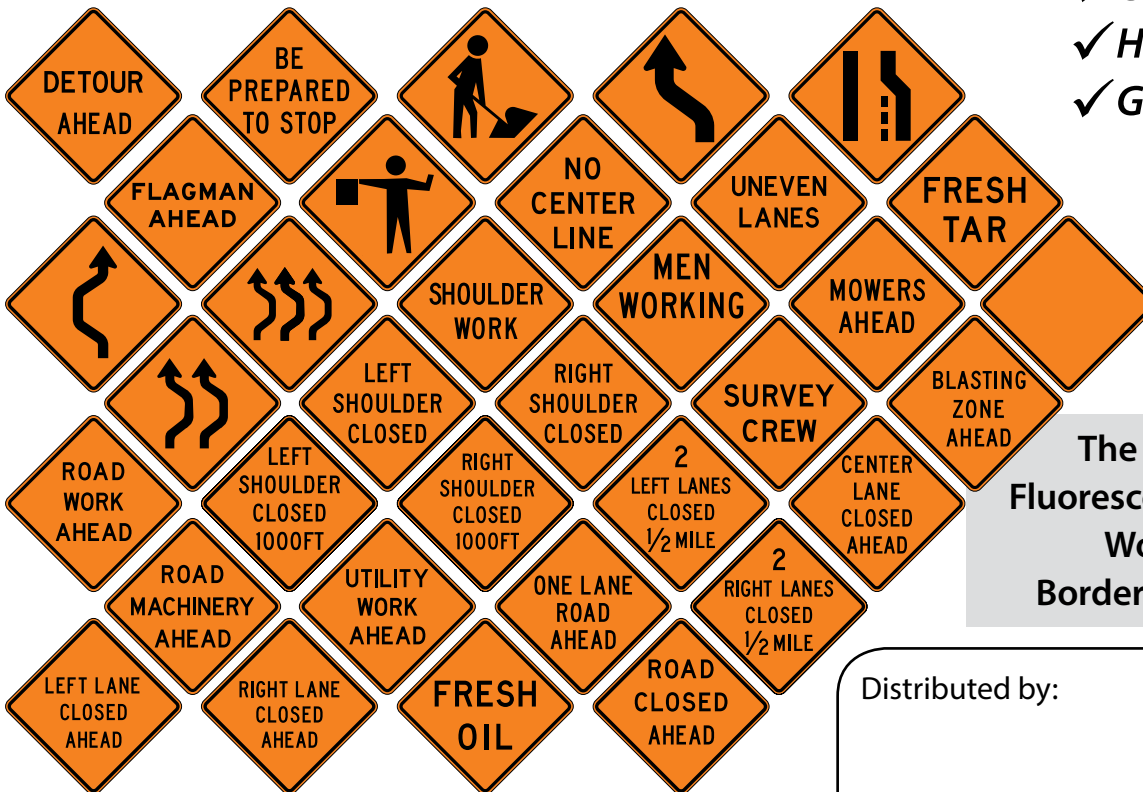

Distributed by: